

HIGHWAY 30

DURING THE CONCRETE PAVING OPERATION, TRAFFIC PATTERNS WILL SIGNIFICANTLY CHANGE:

- TRAFFIC WILL NOT BE ABLE TO PASS THE PAVING MACHINE
- PLUG LOCATIONS OR GAPS WILL BE PROVIDED TO ACCESS THE OTHER SIDE OF THE ROAD
- DO NOT DRIVE ON THE NEWLY PAVED CONCRETE
- FOLLOW DIRECTION OF THE ON-SITE FLAGGERS

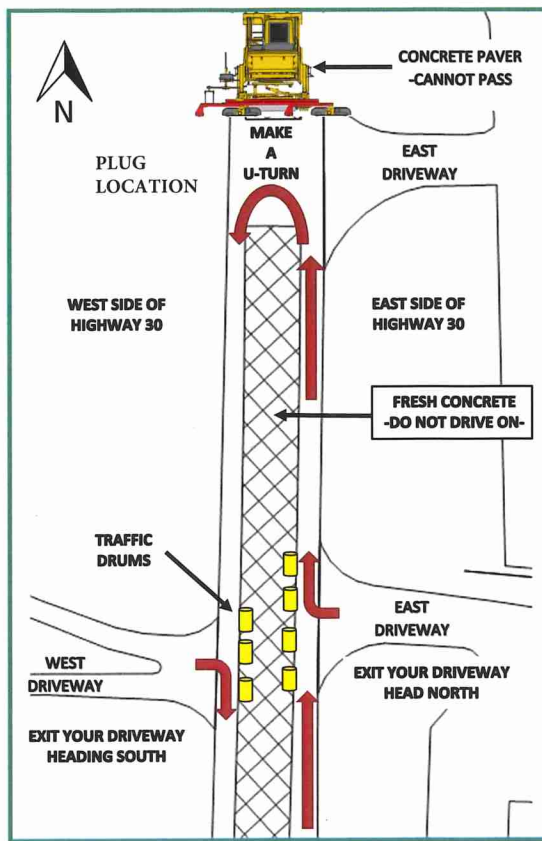

**HEAD SOUTH TOWARD
CITY OF NORTH BRANCH
(USE COUGAR TRAIL DETOUR)**

Traffic Pattern

EAST SIDE OF HIGHWAY 30

PAVER NORTH OF DRIVEWAY

- TAKE A RIGHT OUT OF DRIVEWAY, CONTINUE TO CLOSEST OPENING AND MAKE A U-TURN. HEAD SOUTH TOWARD CITY OF NORTH BRANCH.

PAVER SOUTH OF DRIVEWAY

- TAKE A RIGHT OUT OF DRIVEWAY. HEAD NORTH TOWARD CITY OF HARRIS.

WEST SIDE OF HIGHWAY 30

PAVER NORTH OF DRIVEWAY

- TAKE A RIGHT OUT OF DRIVEWAY. HEAD SOUTH TOWARD CITY OF NORTH BRANCH.

PAVER SOUTH OF DRIVEWAY

- TAKE A LEFT OUT OF DRIVEWAY. HEAD NORTH TOWARD CITY OF HARRIS.

PLUG LOCATIONS

- ASH ST./COUGAR TRL.
- 400TH ST.
- 410TH ST.
- 415TH ST.
- 425TH ST.



CSAH 30 (Forest Boulevard) Improvements North Branch to Harris

Chisago County Public Works
313. N. Main Street Room 400
Center City, MN 55012

Beginning the week of July 12th, Shafer Contracting, the contractor for the County Road 30 (Forest Boulevard) project, will begin concrete paving operations. This will represent a significant change in the current traffic patterns. Concrete paving will begin in North Branch and move north towards Harris. During paving, traffic will not be able to pass the machine. See the reverse side of this postcard for more details on how to access your property or business.

Chisago County Public Works will be updating their website daily by 9 p.m. with details on where the paving operation finished and where it will happen the next day. Motorists of the corridor are encouraged to check the website to plan their route:

<https://www.chisagocounty.us/867/Road-Construction>

Thank you in advance for your patience and cooperation.